

④ 88



FOOD CORPORATION OF INDIA

ISO 9001 - 2000 CERTIFIED

ENGINEERING DIVISION

REGIONAL OFFICE

124, GREAMS ROAD, CHENNAI - 600 006.

TENDER DOCUMENT

VOL. III

DRAWINGS

Name of Work: Construction of Regional Office / District Office building alongwith Commercial Space at FSD, Egmore complex, Chet Pet, CH-31. SH:- Providing SWS of tube wells. (Recall)

CROSS-SECTION OF TUBE WELL

89

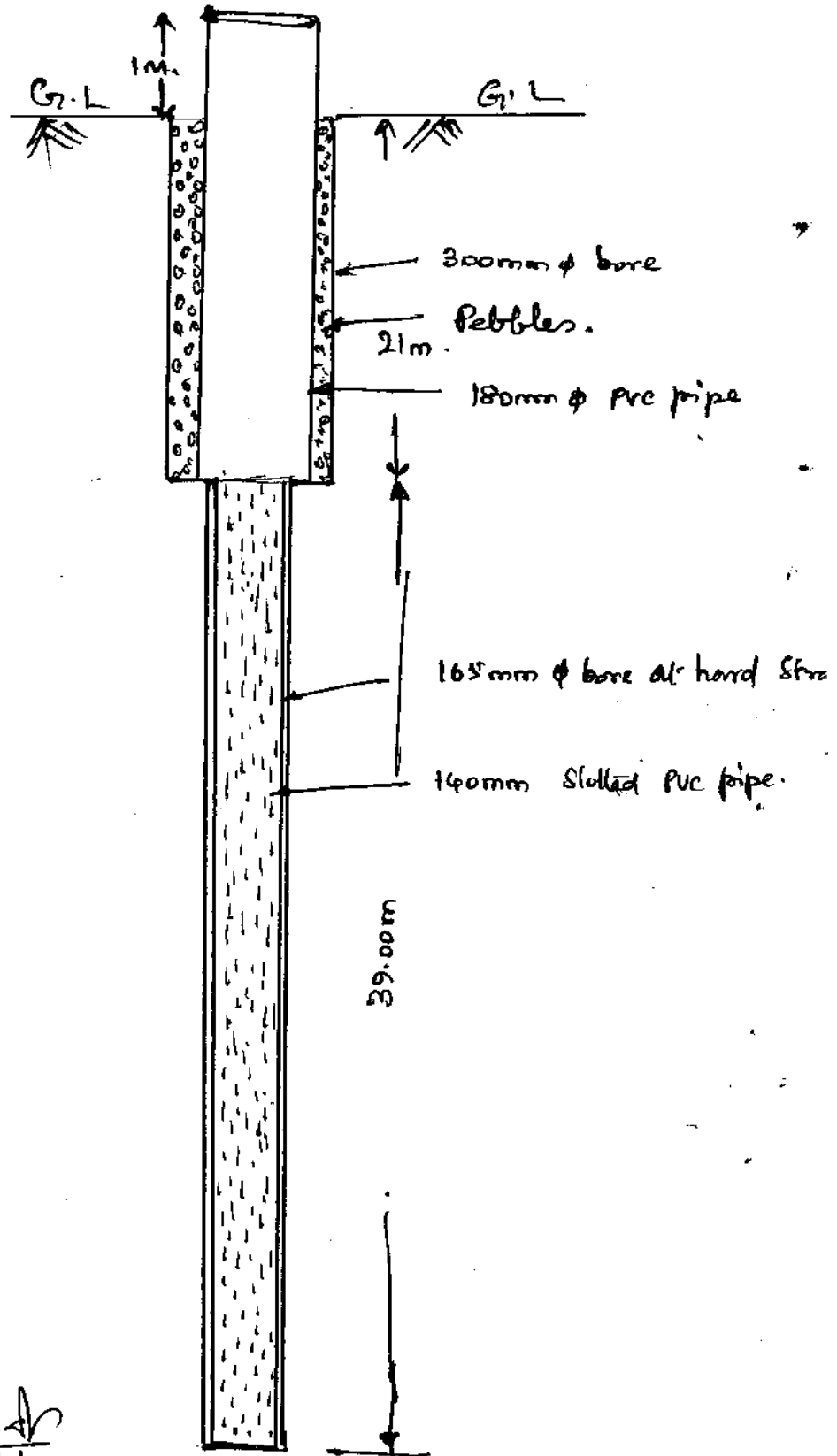

P.K. Muthukrishnan
P.K. MUTHUKRISHNAN
MANAGER (CIVIL)

Contractor

[Signature]
Assistant General Manager

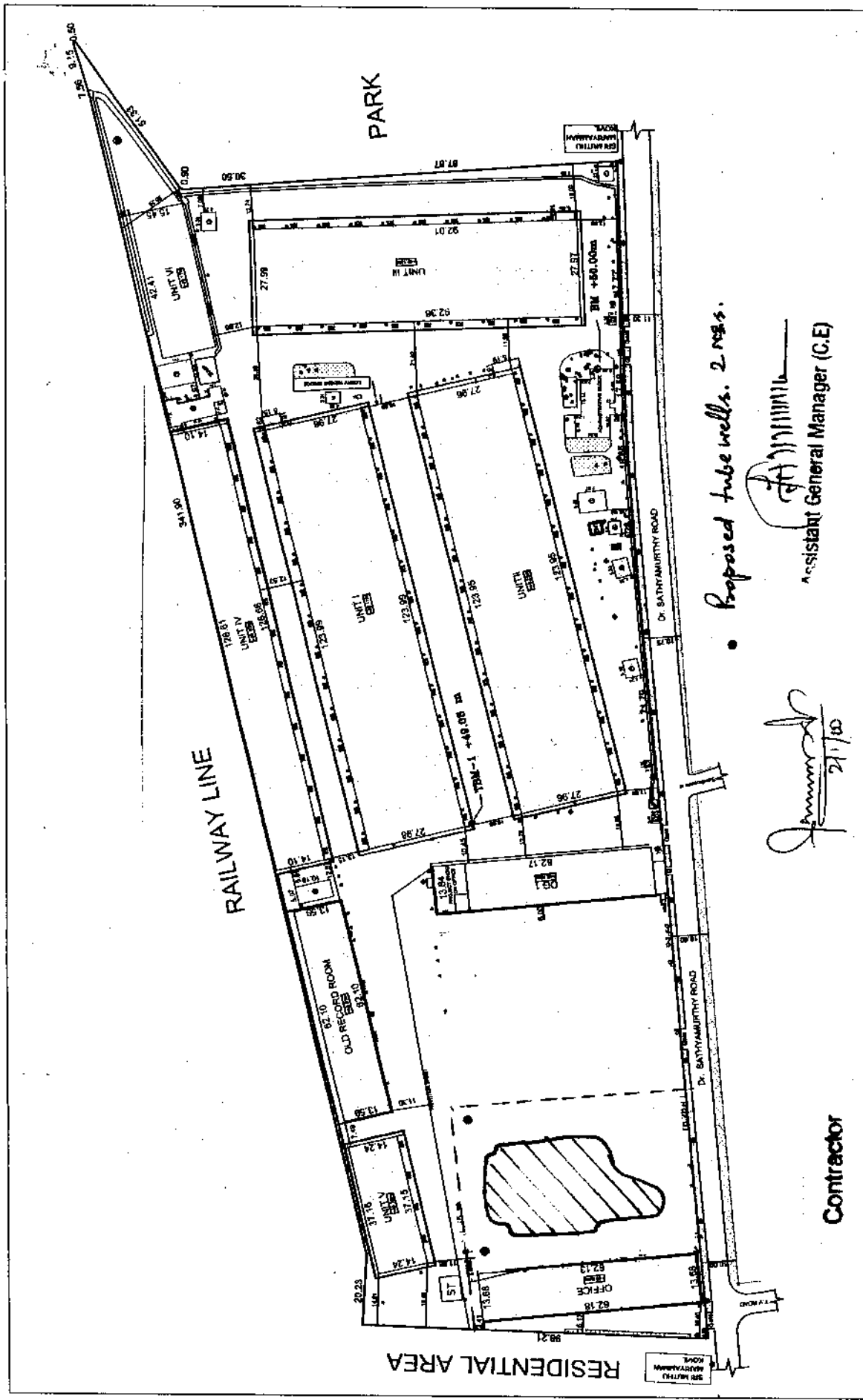

PARK

RAILWAY LINE

RESIDENTIAL AREA

Proposed tube wells. 2 nos.

(Signature)
Assistant General Manager (C.E)

(Signature)
21/12

Contractor

<p>LEGEND</p> <ul style="list-style-type: none"> Compound Wall Outer Compound Wall Inner Benchmark +50.00m Planted Floor Level Building Tree 	<p>NOTES</p> <ol style="list-style-type: none"> 1. Bench mark at Window Sill Level of Administrative Block +50.000m 2. Thickness of compound wall - 0.25m 3. Wall thickness distance 0.75m from Compound Wall 4. Boundary dimensions for Compound Wall Inner 	<p>MISCELLANEOUS BUILDINGS</p> <ol style="list-style-type: none"> 1. MV Room 2. Security Room 3. Rest Room 4. EB Room 5. Gate Toilet 6. Linen Room 7. Security Room 	<p>SECTIONAL</p> <p>SIVAM PLANNERS</p> <p>3rd Floor</p> <p>163 Sathya Murthy Street</p> <p>Chennai - 600 018</p> <p>Phone - 240 5328</p>	<p>ARCHITECT</p> <p>MANDUWALLA QUITAB & ASSOCIATES</p> <p>TURF ESTATE 84/10, Office P.O. Mangaluru</p> <p>Shree Milla Compound Lane, Suburban Road</p> <p>442904/1 - II</p> <p>CLIENT</p> <p>Food Corporation of India</p> <p>14, Chokkikulam Road</p> <p>Chennai - 600 006</p>	<p>TITLE</p> <p>SITE PLAN OF FOOD CORPORATION OF INDIA, CHENNAI.</p> <p>Scale: 1:1000</p> <p>Date: 21/12/2012</p> <p>Drawn by: L. Srinivasan</p> <p>Checked by: S. Srinivasan</p>
---	---	---	---	--	--

6

90